

# TASK CARD 7: how to set up a Wireless Printer

iPad

This card shows you how to connect the forum wireless printer

SELECT WIRELESS DIRECT

1. Switch printer on and press Wireless Direct button till indicator lights up (white).
2. Load printer with photo paper (say 10 sheets) with the glossy side facing you.

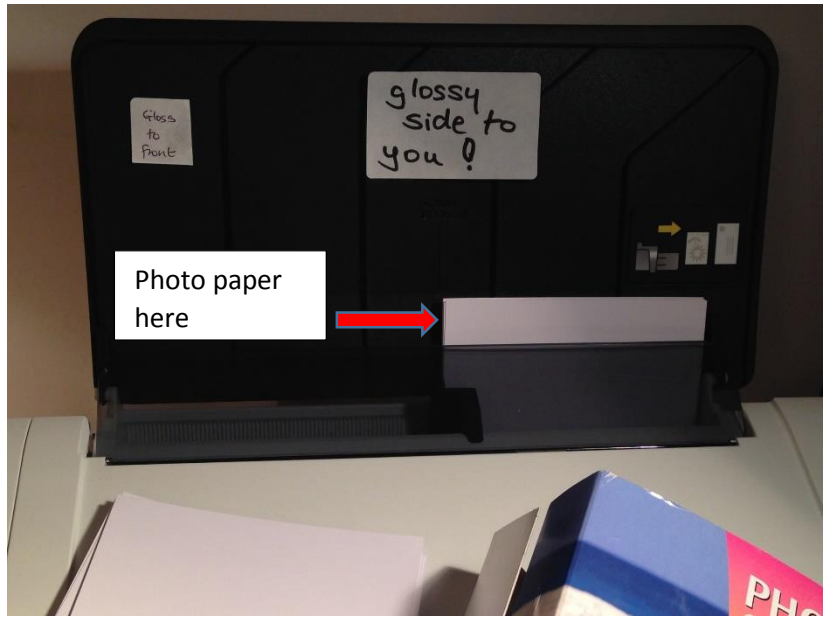
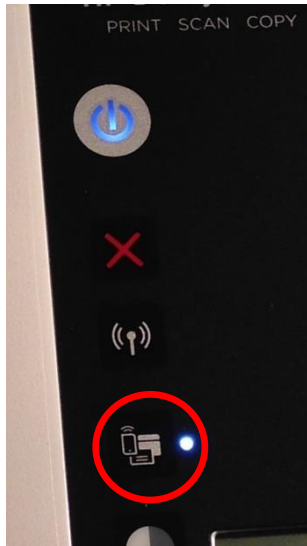

FIND PRINTER WI-FI

On iPad, go to Settings (tap icon)  
When Settings screen opens, select Wi-Fi and tap

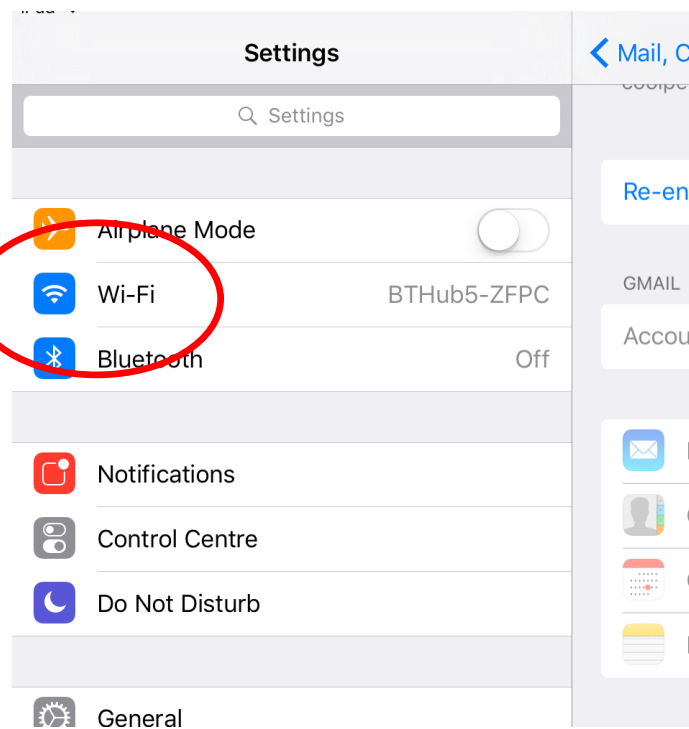
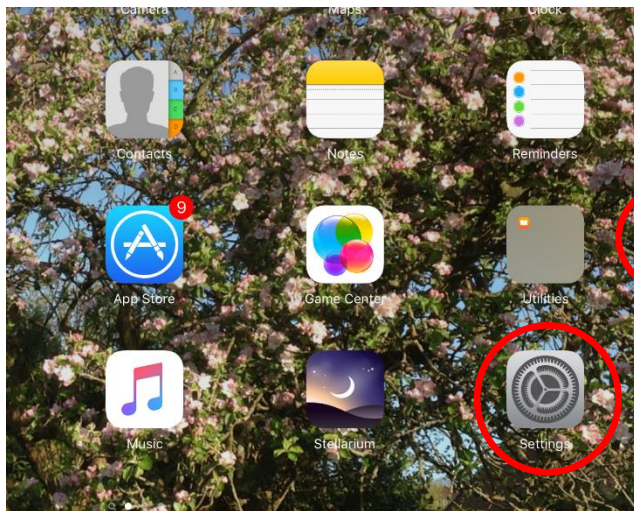

WIRELESS  
CONNECT  
PRINTER  
TO IPAD



On Wi-Fi screen, look for **HP-Print-59 xxxxx** and **tap** to connect iPad to printer  
A prompt may ask you for a password (look on printer for this .. it's clearly labelled!)

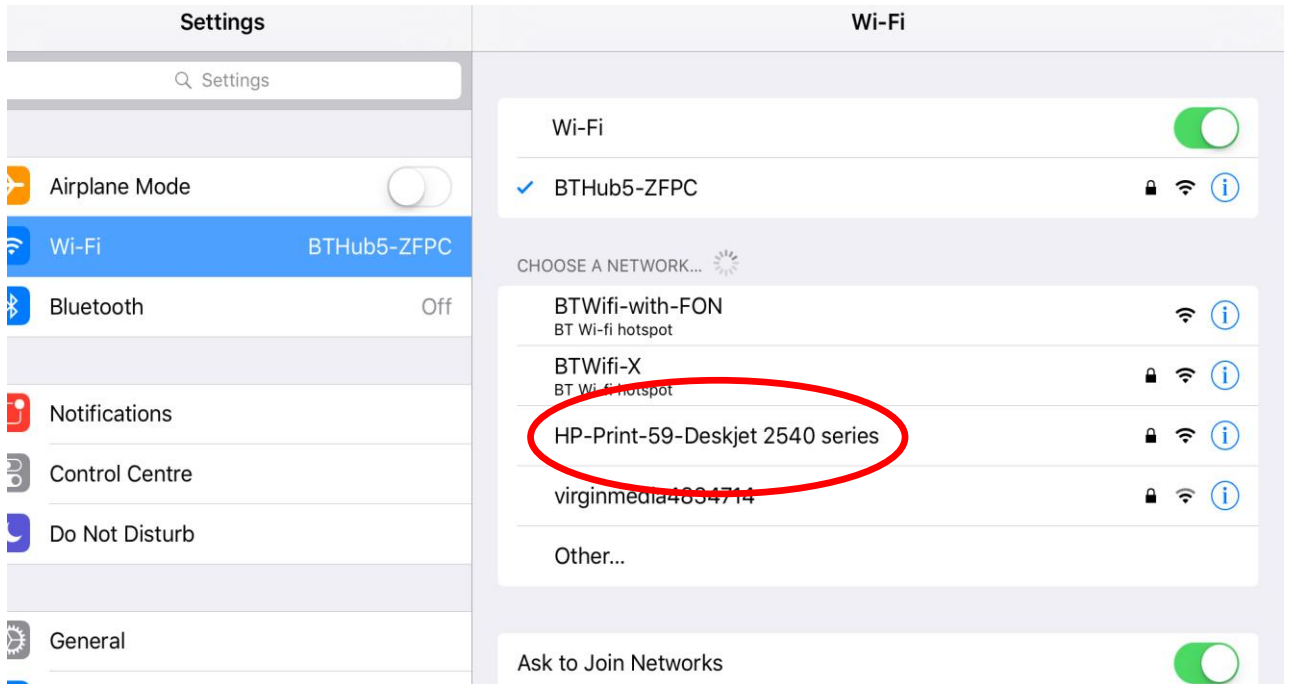

VOILA!  
READY  
FOR  
PRINTING!



The HP-Print-59-Deskjet xx should now be ticked and you are ready to print.  
You can now print your photo or document. When finished reset Wi-Fi (Settings!)

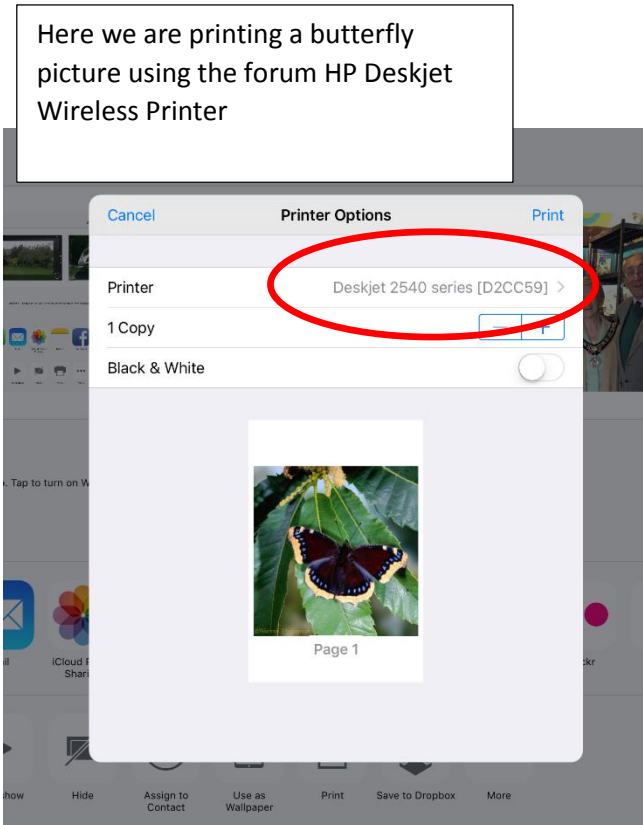

Here we are printing a butterfly picture using the forum HP Deskjet Wireless Printer

